

SMART AKUSTIK

creating silent spaces



ESSEN S





Color
EXTERNAL

INTERNAL

CARPET

ROOF/ BOTTOM PLATE/ DOOR FRAME

Size Specification

External dimensions	W1070*D1120*H2280 mm
Internal dimensions	W900*D950*H1080 (is glass to glass)*H2130 mm
Weight	280kg
Palletizing dimensions	W2220*D1200*H700 mm
Volume	2m ³
Door opening direction	Left door
Door closer	✓

Pallet placement sequence

Functional panel	
Non-Functional panel	
Glass	
Door	
Top	Bottom
+	
Accessory Box	

Material

Frame	6063 aviation aluminum alloy.
Glass	10mm ultra white tempered glass , 4+4 laminated door glass.
Wall	6063 aviation aluminum alloy +1.0mm steel surface + acoustic package + 13mm polyester panel + G350 noise-reducing fabric.
Roof	6063 aviation aluminum alloy + 1.0mm steel surface + acoustic package + polyester panel + G350 noise-reducing fabric.
Bottom plate	Level 25+9mm solid wood plywood + black PVC edge banding + steel frame +25mm adjusting feet + polyester carpet.
Coating	TIGER powder electrostatic spraying.

Specification

Furniture
Bar table (with a cup holder)
W900*D650*H1050
Color: Sparkling beige

Power Configuration
1 220V universal socket
1 wireless charging
1 USB-A + 1 USB-C docks

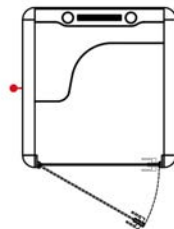
Parameter Configuration

Consumption	40W, electrical appliances access less than 1000W
Ceiling LED lamp	0-20W, 3500K
Wall fan	0.9W, 1500rpm *2
Roof fan	1.92W, 2150rpm*2
Ventilation	1.68m ³ /min, 59.3CFM, air changee rate 50 times/h
Noise reduction	DS,A 28.5 dB (ISO 23351-1:2020)



Ventilation

Silent fans that completely renew the air 50 times per hour



Motion sensor

Lighting and ventilation switch on and *off* automatically

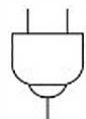

1 power socket+ Z USB

Power for your phone, laptop, etc.



LED lighting

Optimized for an office environment



Noise reduction

28.5 dB noise reduction. Class B according to ISO 23351 standard.



Glass door and back

Acoustic tempered glass

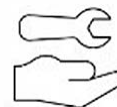

Easy-assembly

Hassle-Free Modular Design



Shock absorbing feet

Adapt the booth to any floor

ESSEN M





Color
EXTERNAL

INTERNAL

CARPET

ROOF/ BOTTOM PLATE/ DOOR FRAME

Size Specification

External dimensions	W1635*D1360*H2280mm
Internal dimensions	W1465*D1190 (1320 is glass to glass) *H2130 mm
Weight	450kg
Palletizing dimensions	W2190*D1410*H935
Volume	3m ³
Door opening direction	Right door
Door closer	✓

Pallet placement sequence

Top
Functional panel
Non-Functional panel
Large glass
Door
Small glass Small glass
Bottom

+
Accessory Box
Material

Frame	6063 aviation aluminum alloy.
Glass	10mm ultra white tempered glass , 4+4 laminated door glass.
Wall	6063 aviation aluminum alloy +1.0mm steel surface + acoustic package + 13mm polyester panel + G350 noise-reducing fabric.
Roof	6063 aviation aluminum alloy + 1.0mm steel surface + acoustic package + polyester panel + G350 noise-reducing fabric.
Bottom plate	E0 level 25+9mm solid wood plywood + black PVC edge banding + steel frame +25mm adjusting feet + polyester carpet.
Coating	TIGER powder electrostatic spraying.

Specification

Furniture
 Bar table (with 2 cup holder)
 W1465*D400*H1050
 Color: Sparkling beige

Power Configuration
 1 220V universal socket
 1 wireless charging
 1 USB-A + 1 USB-C docks

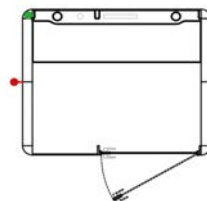
Parameter Configuration

Consumption	40W, electrical appliances access less than 1000W
Ceiling LED lamp	0-20W, 3500K
Wall fan	0.9W, 1500rpm *2
Roof fan	2.4W, 1800rpm*2
Ventilation	2.35m ³ /min, 83CFM, air change rate 45 times/h
Noise reduction	D5,A 28.5 dB (ISO 23351-1:2020)





Ventilation

Silent fans that completely renew the air 50 times per hour



Motion sensor

Lighting and ventilation switch on and *off* automatically



1 power socket+ 2 USB

Power for your phone, laptop, etc.



LED lighting

Optimized for an office environment



Noise reduction

28.5 dB noise reduction. Class B according to ISO 23351 standard.



Glass door and back

Acoustic tempered glass



Easy-assembly

Hassle-Free Modular Design

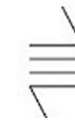

Shock absorbing feet

Adapt the booth to any floor

ESSEN L





Color
EXTERNAL

INTERNAL

CARPET

ROOF/ BOTTOM PLATE/ DOOR FRAME

SOFA

Size Specification

External dimensions	W2200*D1360*H2280 mm
Internal dimensions	W2030*D1190 (1320 is glass to glass) *H2130 mm
Weight	580kg
Palletizing dimensions	W2240*D1410*H1050
Volume	3.5m ³
Door opening direction	Left door
Door closer	✓

Pallet placement sequence

Top
Functional panel
Non-Functional panel
Large glass
Door
Small glass
Small glass
Small glass
Small glass
Bottom
+
Accessory Box

Material

Frame	6063 aviation aluminum alloy.
Glass	10mm ultra white tempered glass, 4+4 laminated door glass.
Wall	6063 aviation aluminum alloy +1.0mm steel surface + acoustic package + 13mm polyester panel + G350 noise-reducing fabric.
Roof	6063 aviation aluminum alloy + 1.0mm steel surface + acoustic package + polyester panel + G350 noise-reducing fabric.
Bottom plate	E0 level Z5+9mm solid wood plywood + black PVC edge banding + steel frame +25mm adjusting feet + polyester carpet.
Coating	TIGER powder electrostatic spraying.

Specification

Furniture	2 Sofa
Negotiating table	W1200*D600
W600*D900*H740	Color: Beige/ Green
Color: Sparkling beige	

Power Configuration
 1 integrated socket (2 AC, 1USB, 1Type-c)
 AC 220V, USB 5V 3.1A

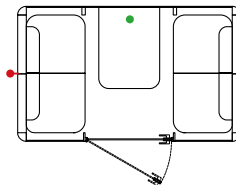
Parameter Configuration

Consumption	60W, electrical appliances access less than 1000W
Ceiling LED lamp	0-20W, 3500K
Wall fan	0.9W, 1500rpm *3
Roof fan	2.4W, 1800rpm *2
Ventilation	4.7m ³ /min, 165CFM, air change rate 56/h
Noise reduction	DS,A 28.5 dB (ISO 23351-1:2020)



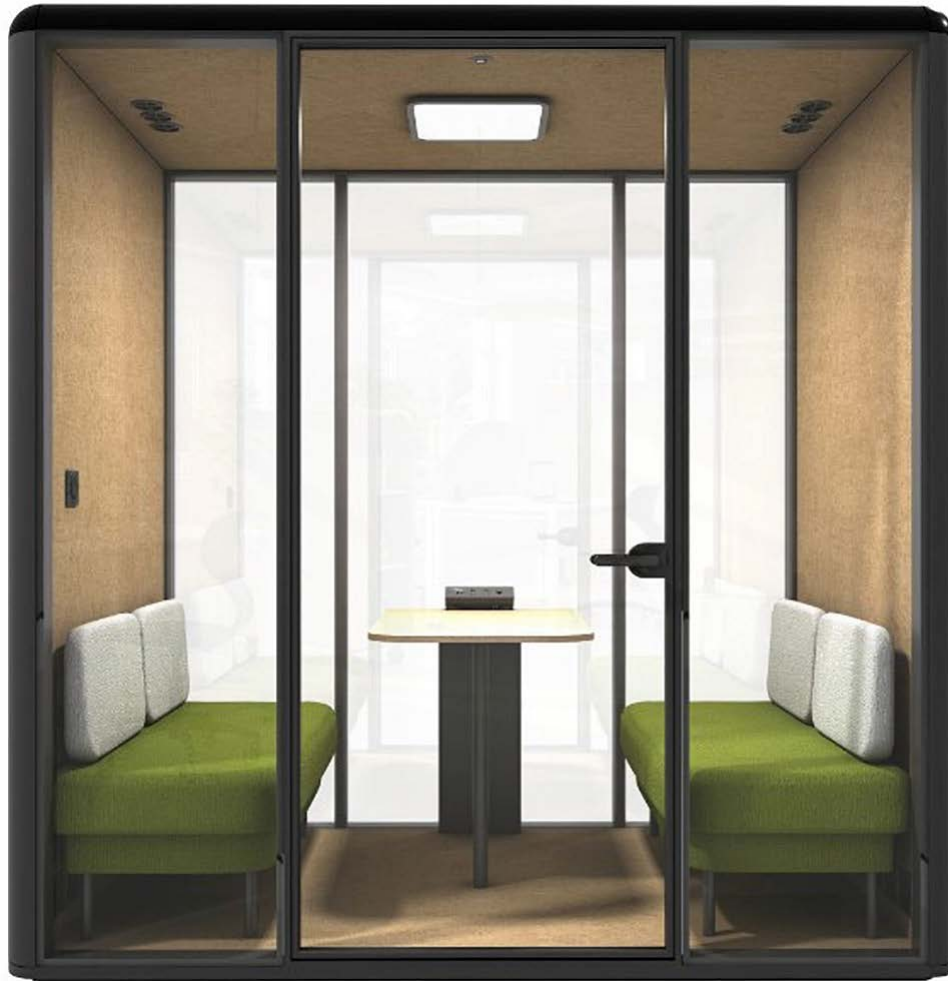

Ventilation

Silent fans that completely renew the air 50 times per hour



Furniture included

Table and sofa set



Motion sensor

Lighting and ventilation switch on and off automatically



3x 220V power outlets + 2 USB

Power for your phone, Laptop, etc.

EJ1

Glass door and back
Acoustic tempered glass



Noise reduction

28.5 dB noise reduction.
Class B according to ISO 23351 standard.



LED lighting

Optimized for an office environment



Shock absorbing feet

Adapt the booth to any floor



Contact D-A-CH

**SMART
AKUSTIK**
creating silent spaces

SMART AKUSTIK
Smart Akustik Solutions GmbH
Fercher-v.-Steinwand-Straße 6
9500 Villach | Austria

Tel: +43 1 934 6604
office@smart-akustik.com
www.smart-akustik.com

